

# Series 1000



*"Quality Since  
1910"*

## **HYDRAULIC CABLE WINCHES**

The rugged construction and versatility of the **1000 Series** makes it adaptable to a wide range of applications. The **1000 Series** direct drive winches are used for industrial pulling and hoisting applications including small cranes, rear load waste packers, drill rigs, fishing boats, marine craft.



**1000 Series Base Mount Shown  
Low Profile Mount Available**

**UP TO 12,000 LBS.  
CAPACITY**

## Bloom Hydraulic Cable Winches – Standard Features

- |                   |   |
|-------------------|---|
| <b>GEAR CASE</b>  | - Made of high strength cast iron. Completely sealed for oil enclosed operation and to keep dirt out.                                   |
| <b>WORM SHAFT</b> | - One piece alloy steel hardened and ground for extra durability. Compact design allows hydraulic motor to be coupled directly to worm. |
| <b>WORM GEAR</b>  | - High tensile aluminum-nickel alloy bronze. Optimum lead and pressure angles transmit maximum power to the drum.                       |
| <b>GEAR RATIO</b> | - 20:1 standard, 10:1, 27:1, 40:1 optional ratios provide optimum efficiency in power and speed.  |
| <b>BEARINGS</b>   | - Worm gear and worm shaft run on tapered roller bearings. Outer end housing has sealed ball bearing.                                   |
| <b>DRUM SHAFT</b> | - 1-1/2" diameter heat -treated alloy steel minimum tensile strength 150,000 psi.   |
| <b>CABLE DRUM</b> | - Tough all steel construction resists breakage or warping.   |

**CAUTION:**

This winch model does not include any kind of holding brake. If your application requires a holding brake choose 1000H, 1000K or 1000W series winches with automatic hydraulic safety brakes.



[www.bloommfg.com](http://www.bloommfg.com)

# **BLOOM**

**Manufacturing Inc.**

Winch Division

**"Custom Engineered Solutions"**

*Lifting  
Pulling  
Hoisting*

Toll Free Number: 1-800-394-1139

1443 220<sup>th</sup> Street,, Independence, Iowa 50644 • FAX: 319-827-1140 • PHONE: 319-827-1139

# 1000 Series

## Model Selection from Performance Data



*"Quality Since  
1910"*

### MODEL EXAMPLE: 10-E-L8-20-LP

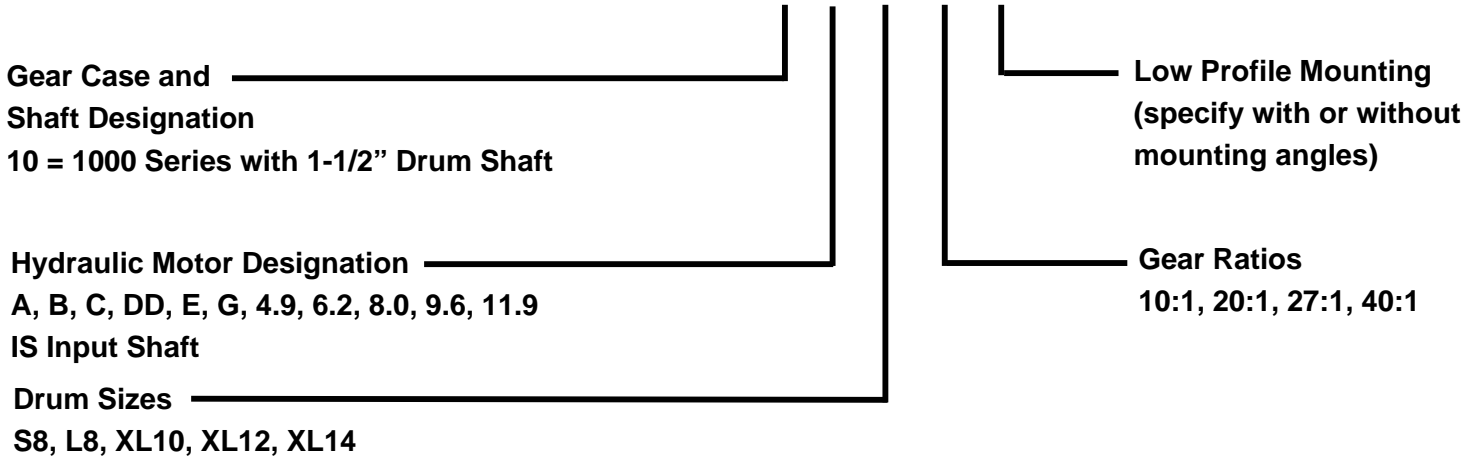

- (10) Indicates winch series. "10" indicates a 1000 Series winch with an 1-1/2" drum shaft.
- (E) Designates hydraulic motor. Motor size is determined from motor performance charts. All motors have 7/8-14 SAE O-ring ports. To order a mechanically driven winch with 1" input shaft use designation "IS". Mechanical winches are available with 1-1/2" shaft models only.
- (L8) Select drum size from chart below:

### DRUM CAPACITY

CABLE DIAMETER (IN.)	1/4	5/16	3/8	7/16	1/2
DRUM "S8" CAPACITY (FT.)	260	160	105	75	55
DRUM "L8" CAPACITY (FT.)	390	240	160	110	80
DRUM "XL10" CAPACITY (FT.)	840	550	340	250	170
DRUM "XL12" CAPACITY (FT.)	1320	840	580	380	280
DRUM "XL14" CAPACITY (FT.)	1900	1180	760	540	410

- (20) Indicates gear ratio. 20:1 is standard. 10:1, 27:1, and 40:1 are also available.
- (LP) Design low profile mounting on 1000 Series winches. 1000 Low Profile Series winches with mounting angles are available only with S8, L8 and XL10 drums. However, it is necessary on all low profile whether the winch is to be supplied "with angles" or "less angles".

# Series 1000



"Quality Since 1910"

## Model Selection from Performance Data

10:1 RATIO (optional)

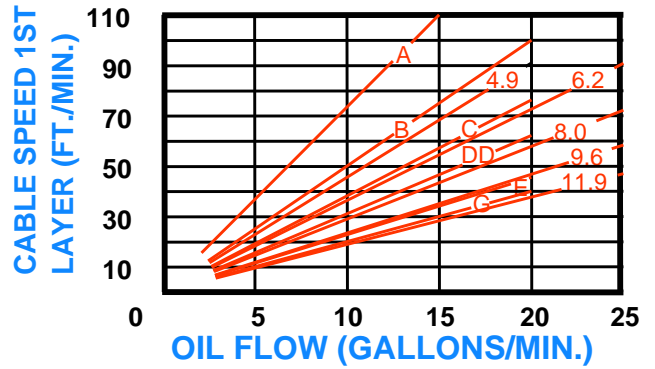
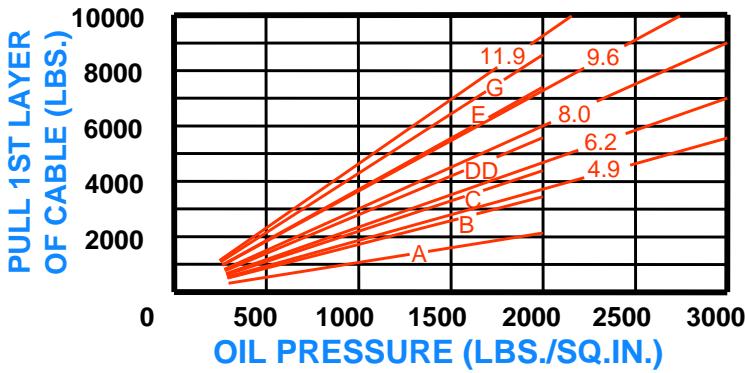

20:1 RATIO (standard)

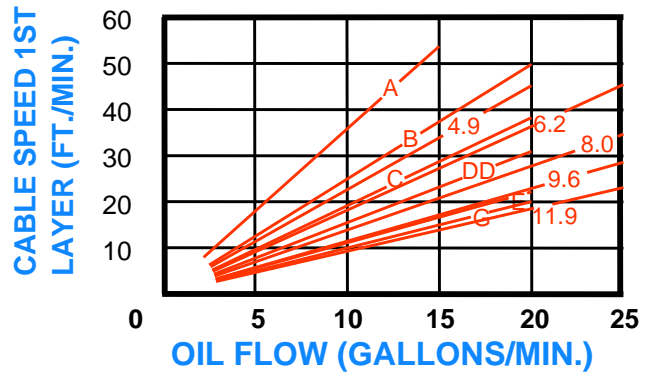
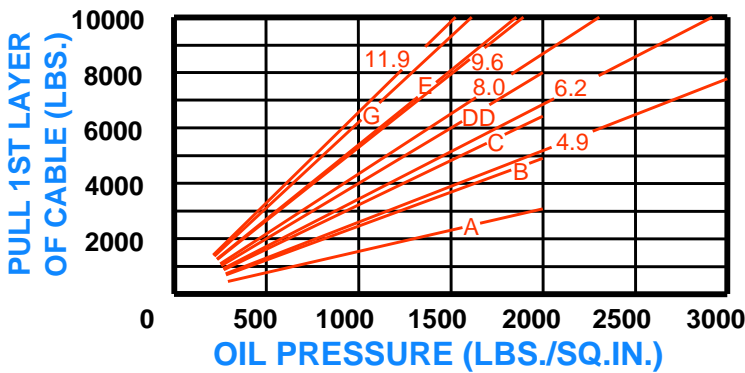

27:1 RATIO (optional)

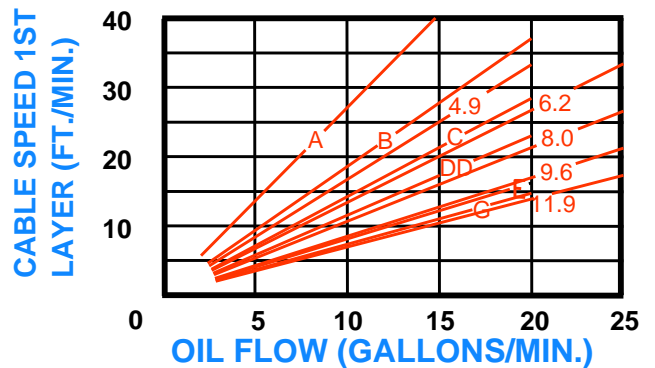
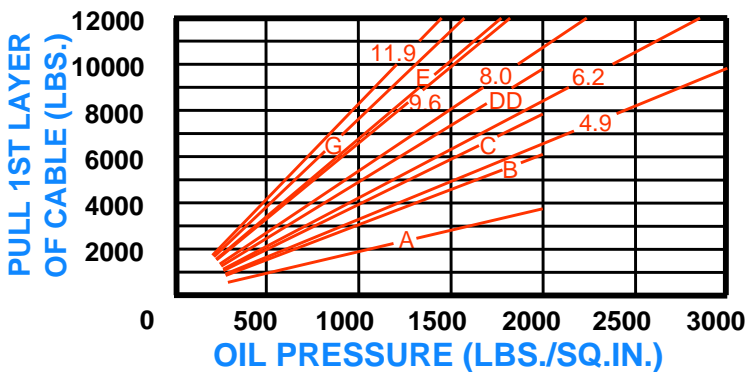

40:1 RATIO (optional)

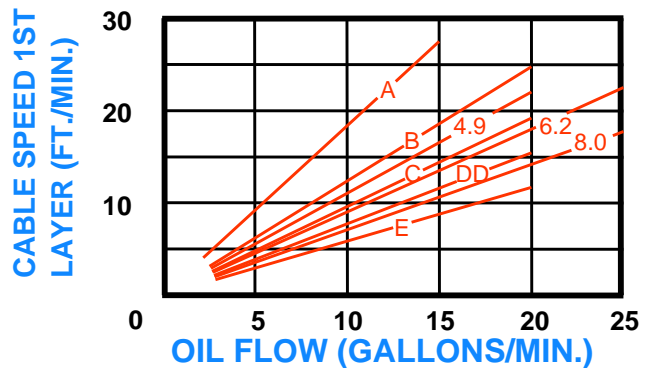
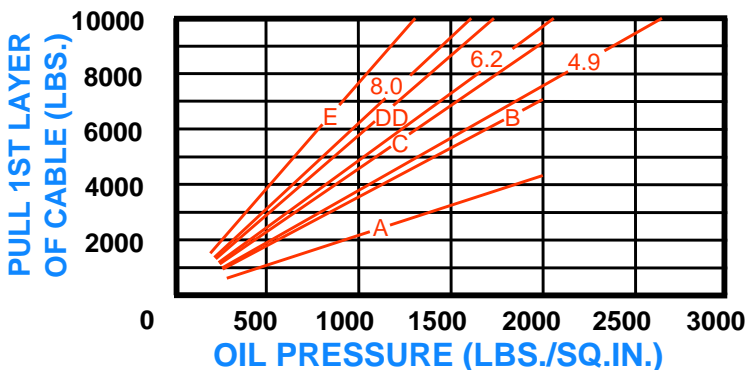



# Dimensional Drawings

1000 Series With S8 and L8 Drum  
Base Mount Model - Direct Drive

“Quality Since  
1910”

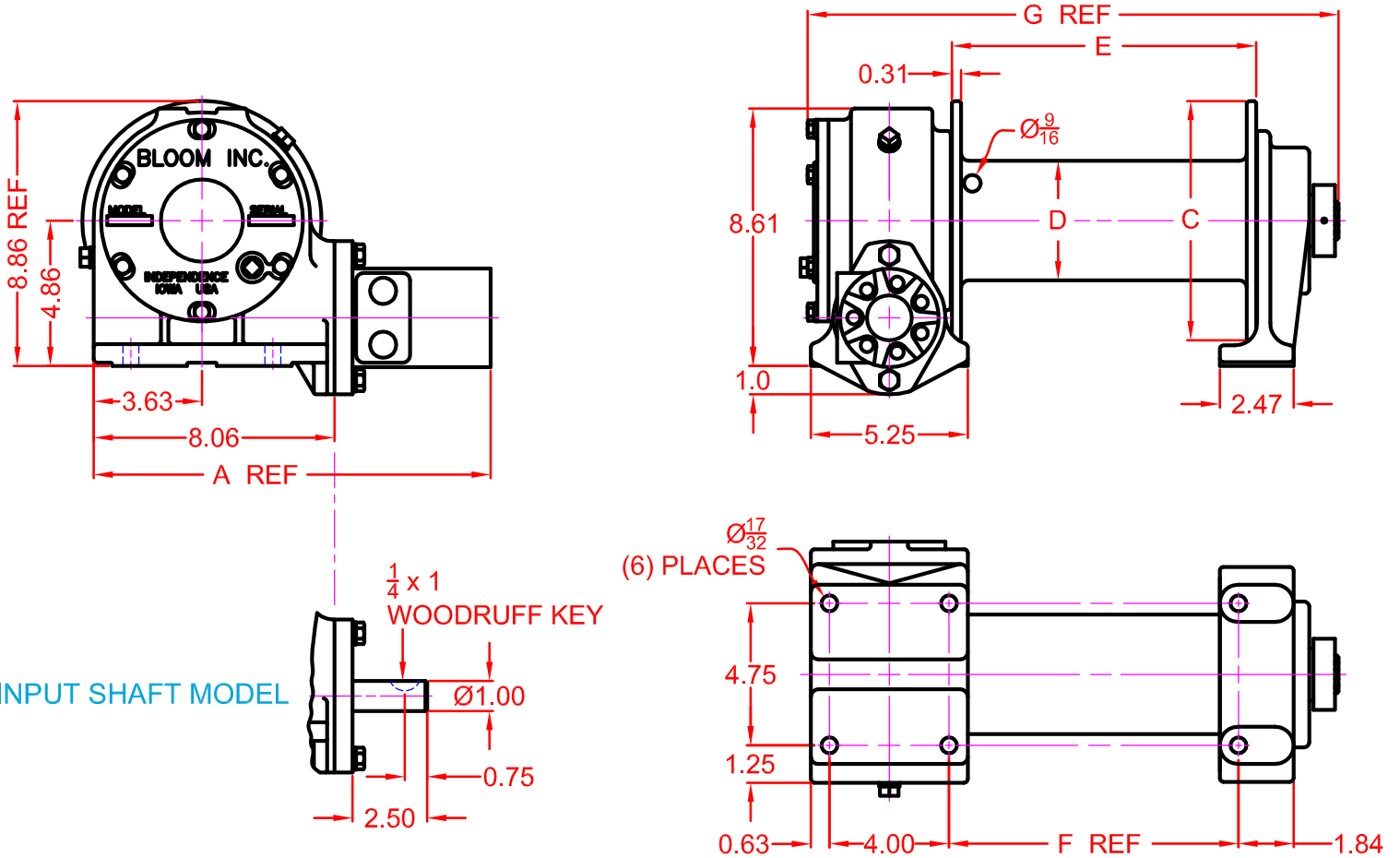

MOTOR DESIGNATION	A	B	C	DD	E	G	4.9	6.2	8.0	9.6	11.9
A DIMENSION	13.28	13.43	13.55	13.68	13.90	14.03	15.32	15.50	15.75	15.75	16.02
DRUM DESIGNATION	WINCH DIMENSION										
	C	D	E	F	G						
	S8	8	4	7.19	6.69	14.50					
L8	8	4	10.19	9.69	17.50						



# Dimensional Drawings

1000 Series With S8 and L8 Drum  
Low Profile Mount - Direct Drive

"Quality Since  
1910"

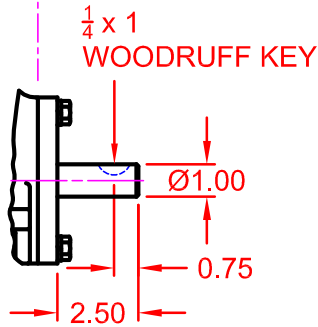
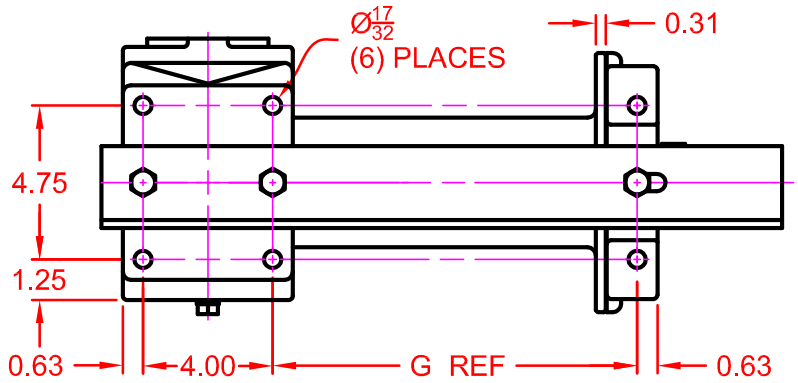
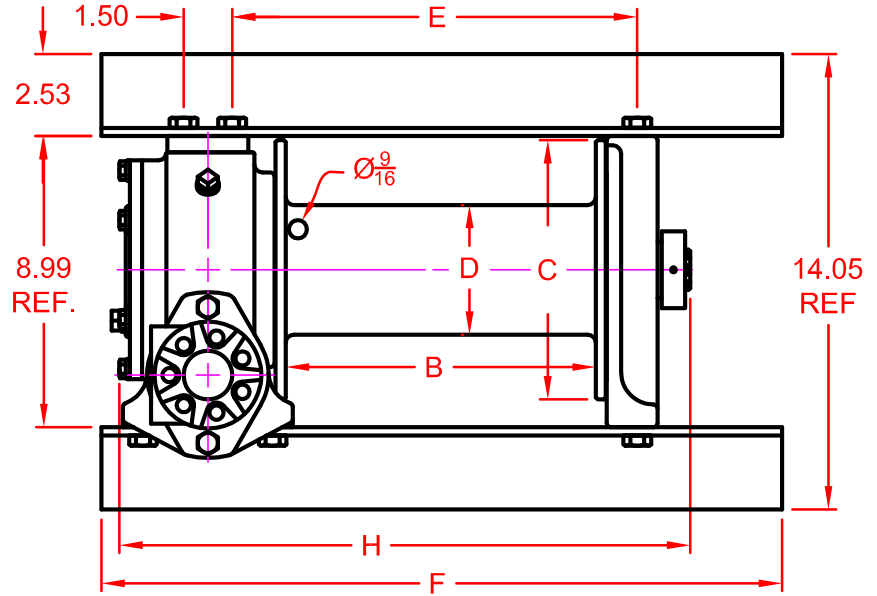
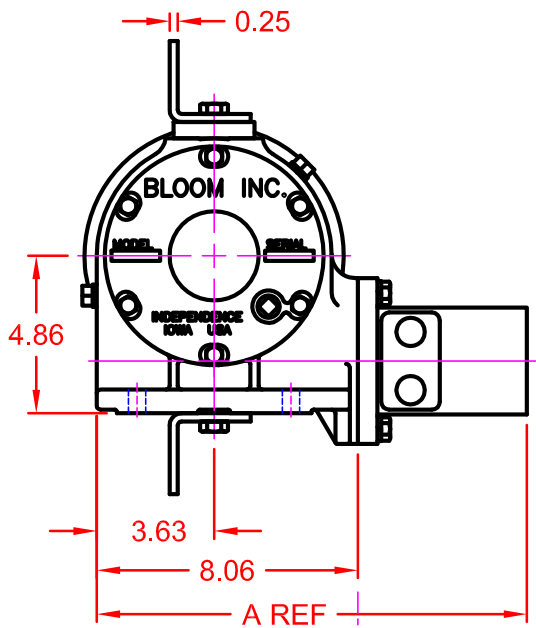

INPUT SHAFT MODEL

MOTOR DESIGNATION	A	B	C	DD	E	G	4.9	6.2	8.0	9.6	11.9
A DIMENSION	13.28	13.43	13.55	13.68	13.90	14.03	15.32	15.50	15.75	15.75	16.02

DRUM DESIGNATION	WINCH DIMENSION							
	B	C	D	E	F	G	H	
S8	6.56	8	4	9.50	18	8.25	14.62	
L8	9.56	8	4	12.50	21	11.25	17.62	



# Dimensional Drawings

1000 Series With XL10, XL12 and XL14 Drum  
Base Mount Model - Direct Drive

“Quality Since  
1910”

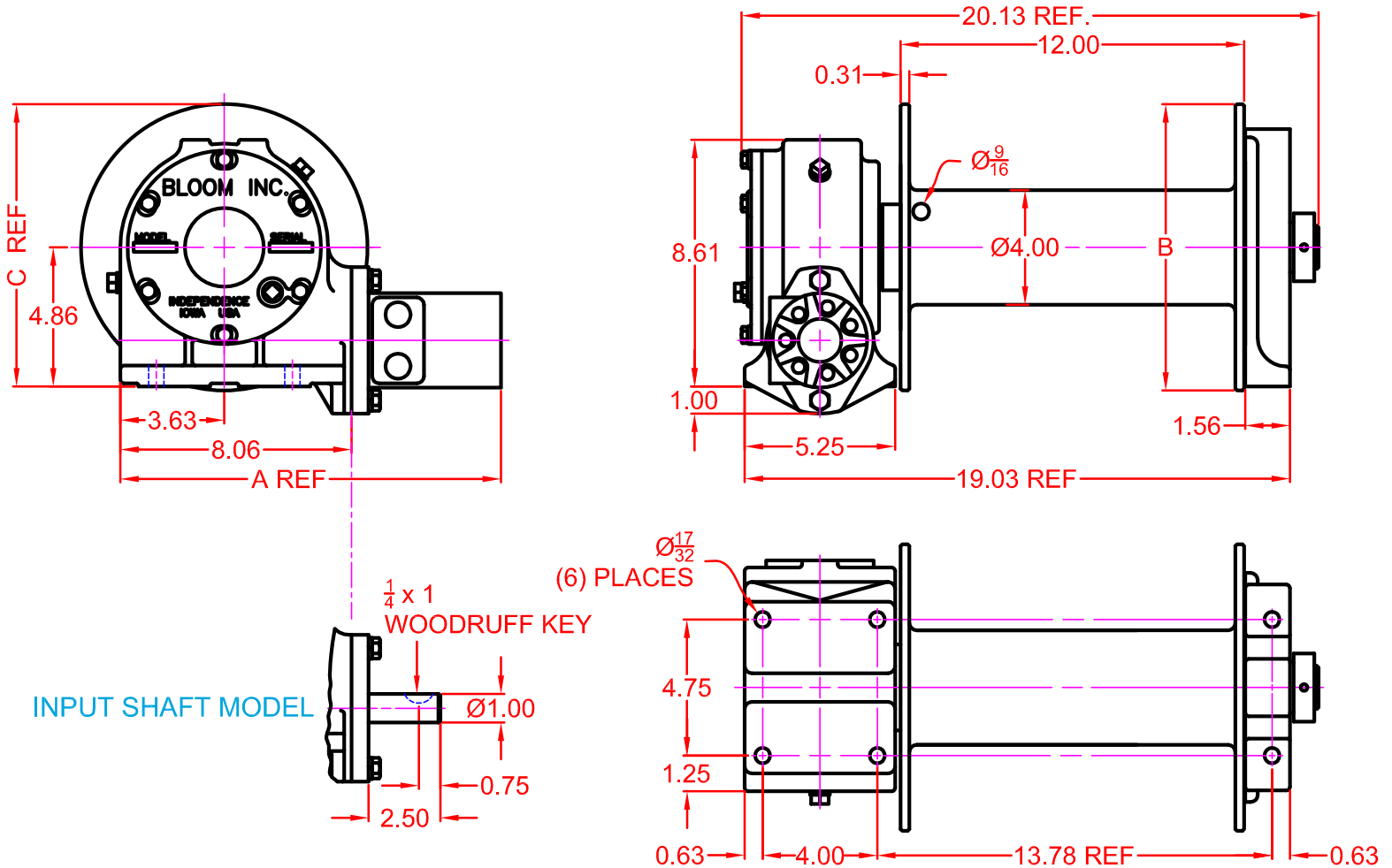

MOTOR DESIGNATION	A	B	C	DD	E	G	4.9	6.2	8.0	9.6	11.9
A DIMENSION	13.28	13.43	13.55	13.68	13.90	14.03	15.32	15.50	15.75	15.75	16.02
DRUM DESIGNATION	XL10			XL12			XL14				
B DIMENSION	10			12			14				
C DIMENSION	9.86			10.86			11.86				

## Correct choice of Directional Control Valves for Bloom Winches

**Tandem Center Spool Valve** – Work Ports are **blocked** in neutral position

Use on all winches that use motor only to hold load.

\*Winches require ridged mounting plate.  
See owner's manual for information about proper mounting plate thickness or call Bloom Sales Engineer at factory

### **WARNING!**

Goods are not intended for use in the moving or lifting of persons!

The winches described herein are neither designed nor intended for use or application to equipment used in the lifting or moving of persons and it is understood that all such use shall be at the sole risk of the user.

The cable clamps on winches are not designed to hold rated loads. A minimum of 5 wraps of cable must be left on drum barrel to guarantee holding of rated load.

Applications of winch where life would be endangered by any event are not recommended.



# **BLOOM Manufacturing Inc.**

## **Winch Division**

1443 220<sup>th</sup> Street,, Independence, Iowa 50644

FAX 319-827-1140 PHONE 319-827-1139

[www.bloommfg.com](http://www.bloommfg.com)