

Assembly Instructions

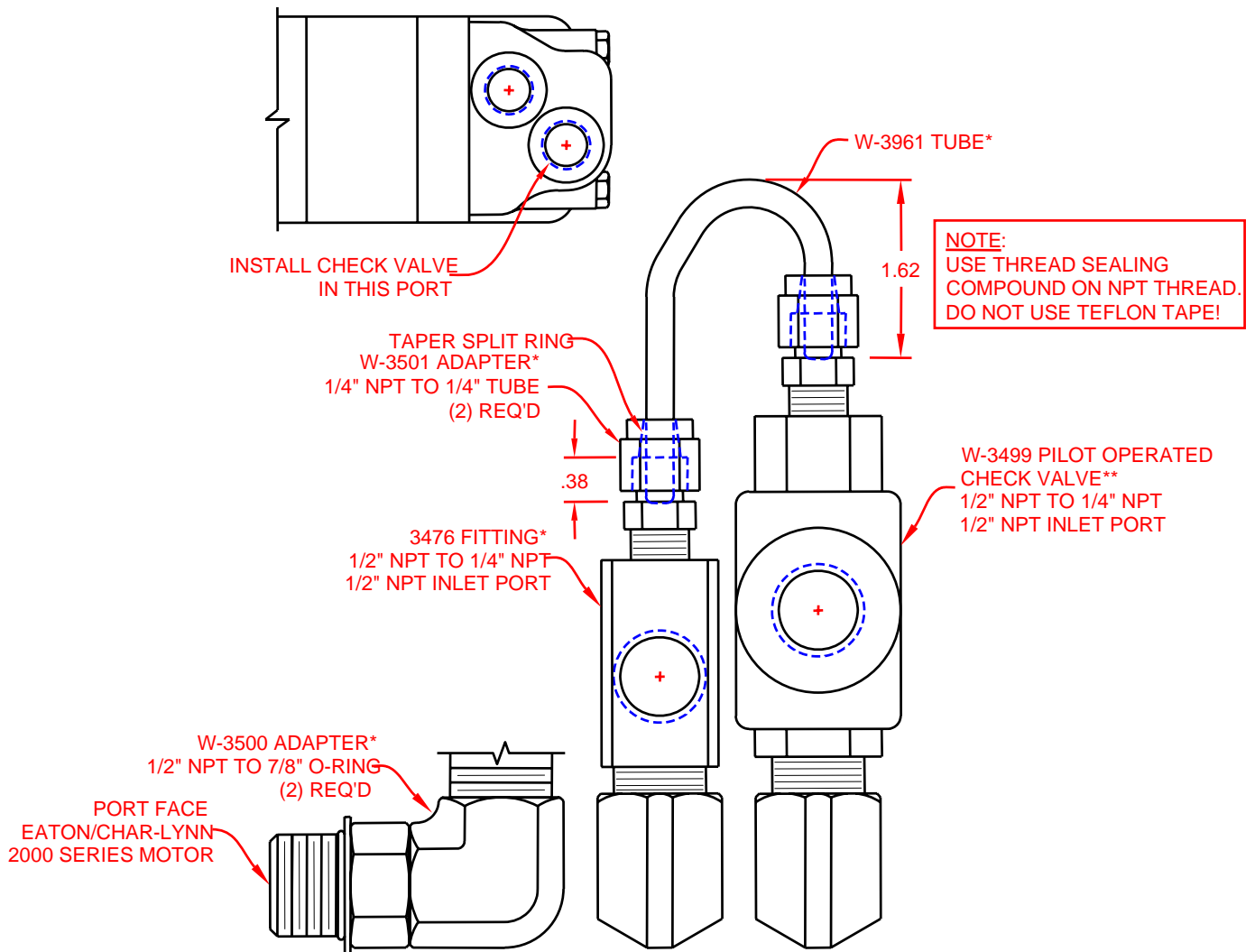

W-3972K Check Valve Kit Eaton/Char-Lynn 2000 Series Motors

- 1) Thread (2) W-3728 pipe adapters into 7/8" - 14 SAE O-Ring motor ports.
- 2) Thread W-3499 check valve into adapter (use a light coat of thread sealing compound). **As shown on drawing below.**
- 3) Thread W-3476 fitting into adapter (use a light coat of thread sealing compound).
- 4) Thread W-3501 Tube to pipe adapters into fitting and check valve.
- 5) Slide W-3501 nut and tapered split ring over each end of W-3961 tube. Insert each end of tube into W-3501 adapter. Push tube in until it clears O-ring in each adapter (about .38"). The top of the tube should end up about 1.62" from top of hex on W-3501 adapter. Fasten nuts and tapered split rings to fittings. Turn nuts hand tight, then tighten one turn or until rear of tapered split ring is flush with nut. **DO NOT OVERTIGHTEN.**



* INCLUDED IN 3972K CHECK VALVE KIT

** NOT INCLUDED IN 3972K CHECK VALVE KIT - ORDER SEPARATELY

Bloom Manufacturing Inc.